

and the indicator sign on the LCD screen of the transmitter.

2. The valid distance of remote control means the straight-line distance between the transmitter and the receiver without obstacles in between. If there are interference signals or signal screening around, the actual remote control distance may vary.

3. This product is for pet training. Only by training, the pet can understand the intention of its owner. Good effect can only be achieved after a period of training.

4. Training sessions should be kept positive and short, about 10-15 minutes long each time.

5. Presently, this product is the most effective and safest tool for training pet. Following the correct operational instructions, you can effectively train the pet and bring it no harm.

### ● Hints to fast results using a Remote Trainer

1. Condition your dog to the remote collar, or electronic collar, by allowing him to wear it while doing something he enjoys instead of only putting it on directly before training. Also, keep the transmitter with you even when you are not training. This will help prevent him from associating the stimulation he receives to the collar or the transmitter.

2. Since the stimulation (sometimes incorrectly called a shock) from the remote collar, or electronic collar, is non-directional, always use it with a long-line or leash and away from people and other animals. Assisting your dog with a leash will also help him learn faster. Do not use the remote collar without a leash or long line until your dog is fully trained.

3. Always use the lowest stimulation level from the remote collar, or electronic collar, as possible for your dog. When choosing the right level of stimulation, begin at level one. If your dog shows no reaction (turns head, scratches at collar,

flicks ears, etc.), go up one level until you find the proper level. Your dog should not vocalize or panic during the stimulation. If this happens, the stimulation level is too high.

4. Never use the remote collar, or electronic collar, to correct or eliminate any form of aggression or biting behavior. In the event your dog is exhibiting such aggressive behaviors, contact a qualified professional trainer in your area.

5. Start with behaviors your dog already understands- do not use the remote collar, or electronic collar, to reinforce commands that have not yet been covered.

If your dog gets confused, help him with the leash and plenty of praise. When reinforcing a command with a correction, it is critical that you do so without emotion, then immediately praise and reward your dog for making the right decision.

6. Training in new locations may cause your dog to become distracted, causing you to reinforce your commands with the remote collar, or electronic collar, more often as a result. The level of stimulation may also need to be adjusted up or down, depending on the exercise or distraction level. It is important that you use a leash or long-line to help your dog perform his commands in new locations.

Training sessions should be kept positive and short, about 10-15 minutes long, so your dog will focus his attention on you. Look for all positive changes in your dog's behavior and be sure to reinforce them with plenty of praise. Remember to always end your training session on a high note. Stop training and play with your dog as soon as he has accomplished a new level of proficiency.

Frequency: 433.825MHz  
Transmitter: 2 x 4LR44/6V  
Receiver: 2 x AAA/1.5V



**NOTE:** Please take out the batteries if you don't use it for a long time. Please don't fold the collar.

Petainer®

## 998DL Remote Pet Training System with Flashing LED Collar

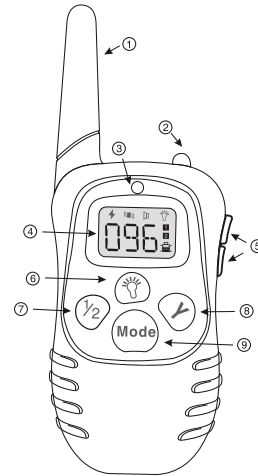

1. Antenna
  2. Led light
  3. Indication light
  4. LCD display
- 000 1-100 level
- ⚡ Static shock mode
  - 🔊 Vibration mode
  - 🔔 Beep mode
  - 💡 Flashing LED Collar
- 1 Channel 1
  - 2 Channel 2
5. Up/down button
  6. Led light button
  7. Channel button
  8. Launch button
  9. Mode button

## ● Features

1. Remote Flashing LED Collar.
2. 100 levels of vibration.
3. 100 levels of static (optional).
4. The levels can be altered by use of up & down button.
5. A tone button activates a tone on the receiver.
6. The system can be used for 1 or 2 receivers.

## POWER SAVING

6. The receiver will TURN OFF if it is unused for 4 minutes.
7. Any movement will activate the receiver into STANDBY MODE.
8. The transmitter will go into STANDBY MODE if there is no operation after 20 seconds and turn off after 2 minute.

## ● Connect the transmitter with the receivers.

Before using this system, please connect your transmitter with your receivers.

1. Install the battery (2 x 4LR44/ 6V) in the transmitter and ensure the polarity is correct.
2. Adjust the channel button to the right one you want to stay.
3. Install the batteries(2xAAA 1.5V) in the receiver (please refer to how to install the batteries in receivers).
4. There is a beep right after installing the batteries in the receiver.
5. Press the Launch button from the transmitter to encode the transmitter and the receiver immediately. There is a beep again from the receiver if you encode successfully.
6. Replace cover and tighten metal probes.

7. If there is no response from the receiver, reinstall the batteries from the receiver and press launch button again.
8. This system could train up to 2 dogs at the same time. To encode different dogs, just change to different channel and repeat the procedure as described again.

## ● Users Manual for Transmitter

- To install the batteries, open the battery cover.
- The battery cover is at the back of the transmitter.
- Open by sliding the cover down.
- Install the batteries (2 x 4LR44/ 6V) - ensure the polarity is correct.
- The transmitter will be TURN ON automatically.
- Press the buttons one by one - the LCD images will change.
- Press the up and down buttons on right hand side to set level.
- Choose channel 1 or 2 for the first or the second receiver.
- The LED light can be used for giving training signals.
- The transmitter will go into STANDBY MODE if not operated for 2 minutes and will TURN OFF if not operated for 5 minutes.
- In STANDBY MODE, press any button (except LED light button) to wake it up.
- To TURN ON the transmitter, hold mode button at least 5 seconds.

## ● Install batteries in the Receiver

Please refer to the pictures below and follow these step by step.

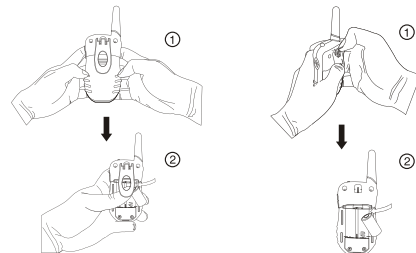

## ● Mistake Prevention function

To prevent your pet from the mistake operation, this system set the working time up to 10 seconds each time. Then you have to repress the operation button again to keep operating.

## ● How to check the static is working

- Use the test light LED - provided.
- Attach the light to the metal probes - select Static Mode - you can see static symbol on the screen- press the LAUNCH button - the LED will flash on.
- Select a low number on the LCD display - put your fingers on the metal probes and press the launch button.

## ● Notes for use:

1. The lifetime of the batteries vary according as how often you use the product. Therefore you should often check the batteries by watching the indicator light in the receiver